

Plan
Scale 1:10,000 @ A1

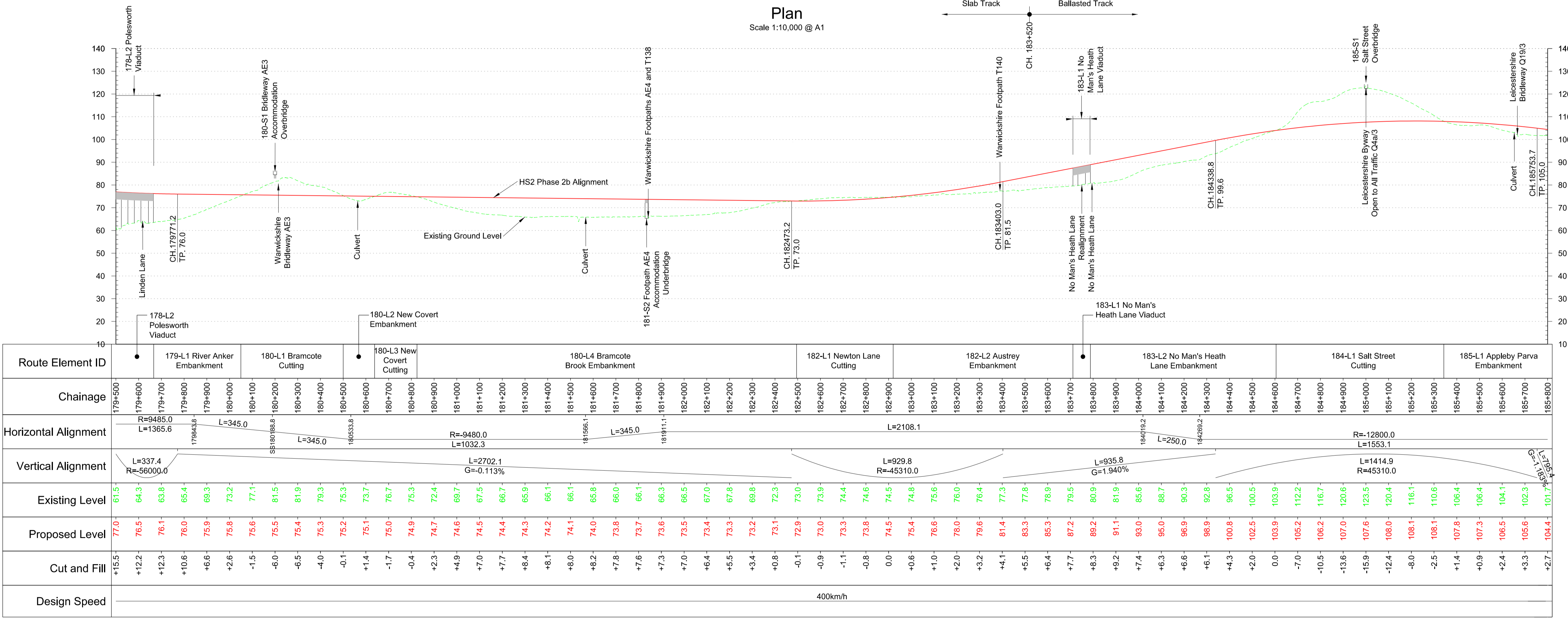

Profile
Scale H:1:10,000 V:1:1000 @ A1

Fit for Acceptance

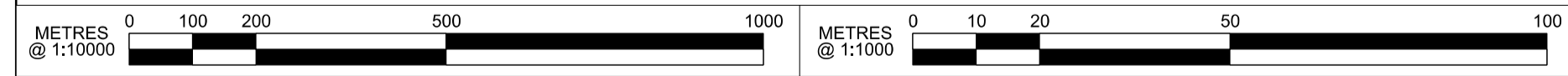

Rev	Description	Drawn	Checked	Con App	HS2 App	Scale with caution as distortion can occur.
P06	Issued for CP2.1	JNO	CVI	AHI		HS2 accepts no responsibility for any circumstances which arise from the reproduction of this document after alteration, amendment or abbreviation or if it is issued in part or issued incompletely in any way.
P05	Issued for CP2.1	DEL	CVI	AHI		© Crown Copyright and database right 2018. All rights reserved. Ordnance Survey Licence number 100049130
P04	Issued for CP2	WJ	MEV	DCL		© Crown Copyright material is reproduced with the permission of Land Registry under delegated authority from the Controller of HMSO.
P03	Issued for CP2	KT	MEV	AHI		This material was last updated on 2018 and may not be copied, distributed, sold or published without the formal permission of Land Registry. Only an official copy of a title plan or register obtained from the Land Registry may be used for legal or other official purposes.
P02	Issued for CP1	JBA	MPR	AHI		

Legends/Notes:

- Depot, station, headhouse, shaft or portal building
- Tunnel portal
- Electricity substation
- Ecological mitigation pond
- Balancing pond
- Pumping station
- Replacement floodplain storage area
- Woodland habitat creation
- Wetland habitat creation
- Grassland habitat creation
- Landscape mitigation planting (scrub / woodland)
- Grassed areas
- Local placement
- Public realm
- Engineering earthworks
- Landscape earthworks
- Rail alignment formation
- Returned to suitable development use
- County boundary
- Borough / District boundary
- Major contour
- Community area boundary
- Existing watercourse
- Watercourse diversions
- New Ditches
- Hedgerow
- Major utility works
- Noise fence barrier
- Existing public right of way
- New, diverted or realigned public right of way
- Public right of way closure
- Tunnels external extent
- HS2 access road
- Realigned highway
- Rail alignment

HS2

Registered in England
Registration No. 06791686
Registered office:
2 Snow Hill, Queensway,
Birmingham, B4 6GA

Creator/Organiser
Aecom Capita Ineco Joint Venture

Zone	L1 Marston to Kegworth	Project/Contract	CEDS Area 2 (CE2)		
Design Stage	Hybrid Bill - Draft Interim Preliminary Design	Discipline/Function	Civil		
Drawing Title	H2EL-01 (Down Eastern Leg)	Drawn	JBA	Checked	MPR
	Sheet 3 of 17	Approved	AHI		
Chainage (e.g. 10+000)	Sheet 3 of 17	Date	23/06/2017	Scale	AS SHOWN
Chainage 179+500 to 185+800	Sheet 3 of 17	Size	A1		
		Drawing No.	2DE02-ACI-CV-DPP-L001-000003		
		Rev.	P06		